

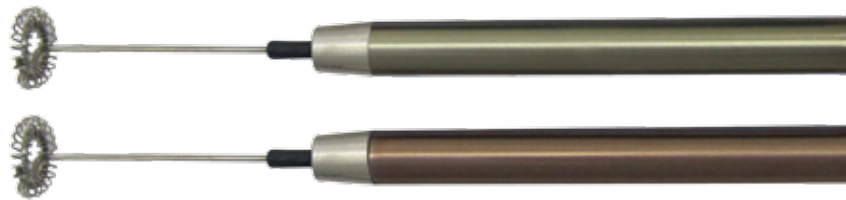

Bar- Küchen- & Weinartikel



introduction

You will recognize some of the world's leading brands on the following pages—testimony to the fact we are capable of working with some of the most demanding customers.

It is impossible for us to show every single product we have produced but hopefully our catalogue will give you a good feel for what we can offer.

Some products and logos in this catalogue are copyright reserved which are for reference only. Clients should get copyright before our company produce it.

index

- | | |
|--|---|
| 3 Soda Siphon | 43 Waiter's Friends |
| 4 Classic Soda Siphon | 48 Kitchen & Bar Utensils |
| 6 Stainless Steel Soda Siphon | 49 Stainless Steel Shakers & Parts |
| 7 Sodamate Home Soda maker | 51 Hip Flask |
| 8 Cream Whipper | 52 Metal Mugs/Cups |
| 9 Cappuccino Maker & Mixer | 53 Ice Bucket (Stainless Steel) |
| 10 Salt & Pepper Mill | 55 Gift Set References |
| 11 Lever Style Corkscrew | 57 Napkin Holders |
| 12 Robot Corkscrew | 58 Bar Table Items |
| 13 Rabbit Corkscrew | 59 Metal Napkin Holders |
| 14 Rechargeable Wine Opener | 60 Coolers with MP5 Video |
| 15 Electric Corkscrew | 61 LED Light Display |
| 16 Deluxe Corkscrew | 62 The LED Menu Models |
| 17 Mini Octopus Corkscrew | 64 Cooler with LED Light |
| 19 Bar Tools with Lovin Logo | 64 Cooler 10-12 Liters |
| 20 Air Pump Cork Opener | 65 Ice Buckets 10 Liters |
| 21 Wine Thermometer Series | 66 Table Cooler 50 Liters |
| 22 Alcohol Sensor | 67 Ice Bucket 5 & 7 Liters |
| 23 Bottle Cooler | 68 Ice Bucket & Coolers other Capacity |
| 24 Zinc Alloy Gadget Series | 73 Pitchers |
| 25 Stylish Bar Tools | 74 Serving Trays |
| 26 Wine Decanter Carafe | 75 Popcorn Feast |
| 27 Wine Aerator | 76 Plastic Glasses |
| 28 Aerating Pourer | 77 Plastic Shakers |
| 29 Electric Wine Preserver | 78 Drop Stopper |
| 30 Wine Saver with Seal Stoppers | 79 Other Promotion Items |
| 31 Vacuum Pump with Seal Stoppers | 81 Drinking Straw Stirrer |
| 32 Wine Decanter & Funnel | 82 Drink Dispenser |
| 33 Stainless Steel Ice Cube | 83 Bar Mat |
| 34 Wine Chilling Stick | 84 Wooden Items |
| 35 Bar Accessories | 85 Grey Goose & Bombay Sapphire Series |
| 37 Wine Accessories | 86 Product Development 1/2/3/4/5/6/7/8/9 |
| 39 Mini Vacuum Stoppers | 91 Bar Tools Collection |
| 41 Wine charms | |

You can make drinks with soda siphon !
Cocktail, Pop drinks, Cream soda mousse,
Sparkling water, Sparkling juice, Soda water

Aluminum Soda Siphon

500ml & 1000ml

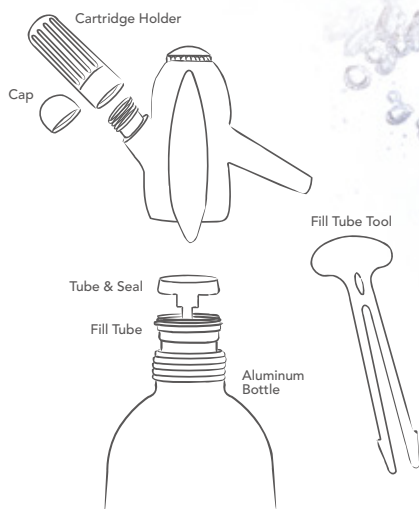

Sparkling water, also called soda water or seltzer, is plain water that has carbon dioxide added to it. SODA water is good for health as alkaline food. It helps stomachic, prevent skin aging, improve one's looks and to nourish our skin. It makes drinking water just a little more fun. Some like the taste but may not want all the calories and sugar that come with drinking soda pop.



LV23 - 1000ml

LV24 - 500ml

Aluminum Soda Siphon

Volume	500ml	1000ml
Dimension (LxWxH)	105x105x270 mm	105x105x330 mm
Weight	650g	920g
Packing	12pcs/Ctn	12pcs/Ctn
Ctn Size (LxWxH)	38x29.5x34 cm	44x33.5x35 cm
GW/NW	9.5/8.5KGS	13/12KGS



Classic Soda Siphon

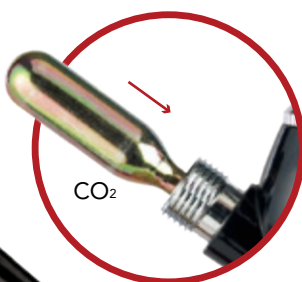

LV20



Gold



Red



Purple



Green



Blue



Logo



LV21



LV22



Classic Soda Siphon

METAL PLATE BRANDING ARE WELCOME



RED ADAPTER



BLACK MESH



METAL RING



DECAL PAPER PRINT



PLATING PLATE



DECAL PRINT PLATE



CUSTOM BOX



Stainless Steel Soda Siphon



INSTRUCTION FOR USE



1. Please always inspect the items to make sure it is clean and free from any damage or wear before filling your soda siphon.



2. Fill the soda siphon with water to full level with fill tube located about two-thirds the way up the bottle. You may use very cold water for best results. Insert fill tube before inserting the long plastic tube & seal into the top of the bottle.



3. Firmly screw on the head of the siphon with clockwise and taking caution not to over-tighten.



4. Insert one CO₂ charger into the cartridge holder.



5. Screw the cartridge holder onto the head of the siphon until you hear a hiss and the gas is released. Only use one charger. Do not remove cartridge holder for a minimum of one minute.



6. Shake soda siphon well. Allow charged water to 'rest' for a minimum of 10 minutes to achieve full effervescence.



7. To dispense water gently press lever and direct water towards the side of the glass. Refrigerate the soda siphon for at least one hour will give you better results. It is preferable not to keep the soda water for more than two days.



CAUTION: Only use one 8 gram CO₂ cartridge!

Soda siphon and cartridge are highly pressurized and misuse could cause harm to user and/or damage the product.

Please always keep your soda siphon and soda chargers out of the reach of children. For safety, never stand directly over the soda siphon or hold close to your body when charging it. Never expose your soda siphon to heat or extreme cold. We terminate the liabilities and responsibility for any misuse.



Home Soda Maker

Soda Siphon 1000ml

LV25



Sodamate™ home soda maker are made with safety in mind.

Soda bottles are made from a special plastic that does not explode. Instead, it expands under pressure.

Sodamate™ home soda maker also has double safety valve that release CO₂ gas when it reaches a certain point.

Safety hole release CO₂ gas when the gas pressure is to high during gas input procedures.





Cream Whipper

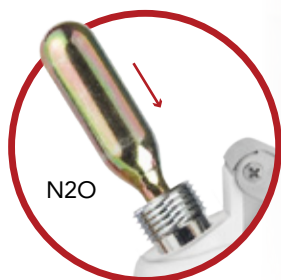

Plastic Adapter



CW-1 (1000ml)

CW-2 (500ml)

CW-3 (250ml)

Aluminium Adapter



CW-1A (1000ml)

CW-2A (500ml)

CW-3A (250ml)

Stainless Steel Adapter



CW-1M (1000ml)

CW-2M (500ml)

CW-3M (250ml)

Colors





Cappuccino Maker & Mixer



— Stainless steel
whisk



— Stainless steel
handle

— On/Off
switch

CM01



Brown



Green



Light Blue



Blue



Red



CM02



salt & pepper mill

mechanical usage



electronic salt & pepper mill

electronic & mechanical usage





Lever Style Corkscrew

FEATURES:

- Ergonomic design to remove any cork easily and effortlessly.
- Superior quality and simple to use.
- Fit for all types of bottle.
- Release cork with one lift up and down action.



LV-797A



LV-797B



1. Push buttons to remove foil seal.



3. Hold the corkscrew tight on bottle and screw into the cork gradually.



2. Lift up the handle and place the corkscrew above the bottle, aim at the cork.



4. Lift up the handle and the cork is removed.

To release cork:

Hold the corkscrew tight when the cork is inside the screw and lift up the handle. The cork will release.



ROBOT CORKSCREW SET

WITH FOIL CUTTER &
EXTRA SCREW

Lovin lever corkscrew now has a vertical companion. And like the original Octopus, ROBOT pulls a cork in 3 seconds, ejects the cork automatically.

This ROBOT has a die-cast metal lever handle and comes in your choice of hi-sheen red racing-car finishes.

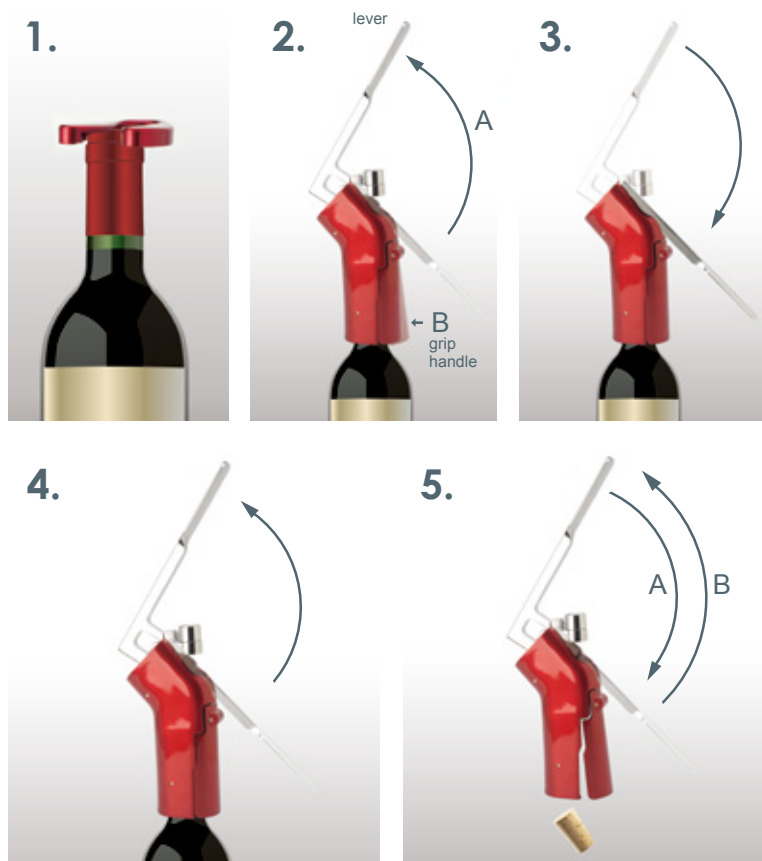

User Instructions

1. Place the foil cutter over the bottle mouth and twist the foil cutter until foil is cut.
2. Put the Robot Corkscrew over the bottle neck while the lever is at the top(A) and press down the grip handle(B).
3. Flip down the lever to spiral screw into cork.
4. Remove the cork by flip up the lever.
5. Release cork, flip lever down and up.



Foil cutter



Extra screw included



Rabbit Corkscrew

with foil cutter

- Pulls a cork in 3 seconds.
- Automatically ejects cork.
- All-metal lever and gears.
- Works on all bottle sizes and cork types.



LV798B

LV798C



LV798D

LV798E

Pulling a cork with the Rabbit is as easy as **1 2 3!**



Insert corkscrew



Pull cork



Eject cork



LV798

Corkscrew, foil cutter
& extre spiral

DIRECTIONS:

- Before pulling cork, remove foil cap with separate foil cutter included. Place on top of wine bottle. Press two sides firmly against foil cap while turning bottle (Drilling through foil caps can shorten the life of the spiral.)
- To operate: Raise lever handle and place corkscrew on bottle top. Push handle down to insert corkscrew. Squeeze bottom firmly and raise handle to remove cork. Push handle down and raise it to eject cork from spiral.
- Don't remove the cork manually from the spiral after pulling it. Always use the easy automatic cork removal.



Rechargeable Wine Opener



- Compact version.
- Just a simple press, the cork will move out.
- Another simple press, the cork ejected in a second.
- Integrated wine opener with foil cutter.
- Different color are available.
- LED keeps flashing when wine opener is being charged, stops flashing when full.



LV35



1. Integrated foil cutter removes foil seal.



2. Put wine opener above the bottle; aim at cork; press the bottom part of button and screws into the cork in bottle. The cork will lift up from the bottle. Cork is automatically removed.



3. Press upper part of button. The cork is ejected from opener within few seconds.



Indicator for number of bottle to be opened before recharging.

LV36



ELECTRIC Corkscrew

- Electric and rechargeable wine opener.
- Designed to fit all traditional wine bottles.
- Easily opens up to 30 bottles fully charged with the touch of a button!
- Operating time: 7 seconds.
- LED blue charging indication light.
- Noise: <78db
- Integrated wine opener with foil cutter base.
- Blue LED keeps flashing when operating.



LV37



Blue LED



Foil cutter base



1. Integrated foil cutter removes foil seal.

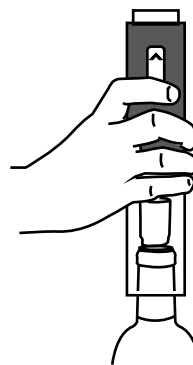

2. Put wine opener above the bottle; aim at cork; press the bottom part of button and screws into the cork in bottle. The cork will lift up from the bottle. Cork is automatically removed.

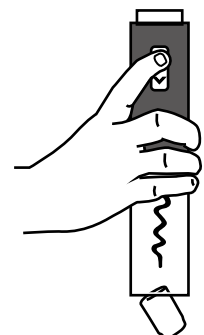

3. Press upper part of button. The cork is ejected from opener within few seconds.



Deluxe Corkscrew

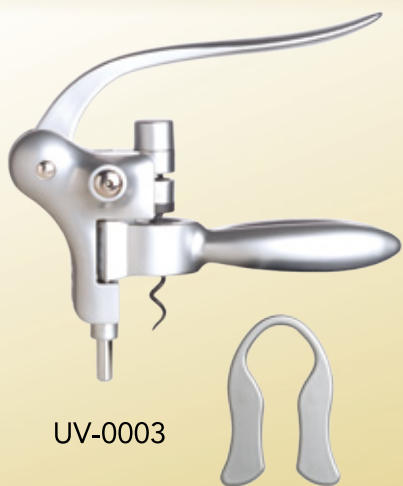

UV-0003



UV-0004



UV-0005

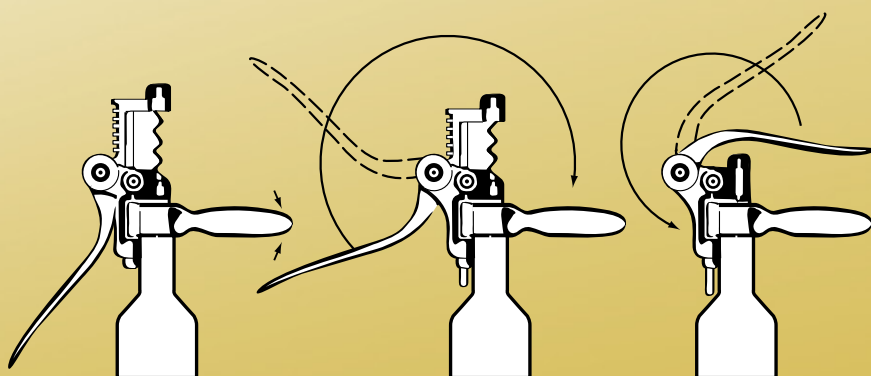

UV-0006



MINI OCTOPUS CORKSCREW

- Professional Quality
- Simple to use
- Quick as a flash to de-cork
- Ergonomic design
- Fit for all types of bottle



Extra screw
included



Built-in Foil
Cutter

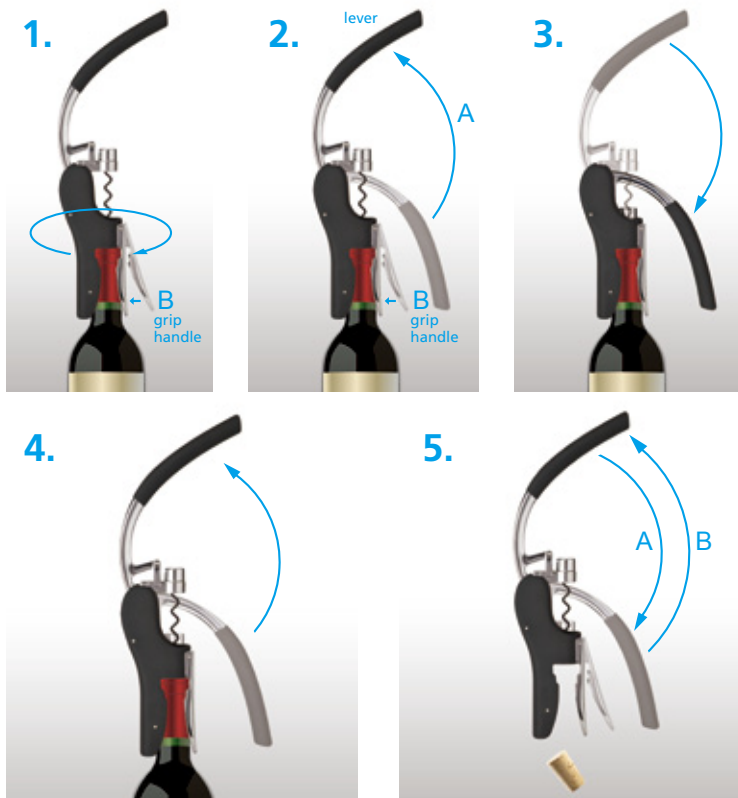

User Instructions

1. Place the built-in foil cutter over the bottle mouth and press down the grip handle(B), twist the foil cutter until foil is cut.
2. Put the Deluxe Corkscrew over the bottle neck while the lever is at the top(A) and press down the grip handle(B).
3. Flip down the lever to spiral screw into cork.
4. Remove the cork by flip up the lever.
5. Release cork, flip lever down and up.



CT15



MINI OCTOPUS CORKSCREW



UV007A



- Opens a bottle in just seconds!
- Easy to use!
- Works with all winebottles!
- With integrated foil cutter!
- With integrated foil cutter and spare spiral

Remove the foil from the wine bottle with the integrated foil cutter. Put the wine opener on top of the bottle's neck and move up or down until the 2 blades (see the picture) are at the required height. Now press together and spin around one time.

Open the lever, put the corkscrew onto the bottle and press the handles together.

Hold the handles pressed and close and open the lever.

Take the corkscrew from the bottle. To remove the cork hold the handles together and close and open the lever.

bar tools with Lovin logo



CT14



CT24



CT25



CT33



CT34



CT30



CT37



CT35



CT31



CT22



CT23



CT36



CT38



CT32



Air Pump Cork Opener

with retractable foil cutter



LV210

How to use:

1. Use the foil cutter to remove the foil cap.
2. Insert the needle into middle of the cork and ensure the needle has passed through the entire cork.
3. Press the opener to pump air into the bottle by pushing up and down action, until the cork slide out of the bottle.
4. Release the cork by hand from opener's needle

CAUTION:

1. Don't use this bottle opener for plastic cork and sparkling wine.
2. Please keep the opener away from children, the needle and foil cutter are very sharp.



LV211
Mini Pump
Stopper



LV212
Pour Aerator



LV213
Drop Stop
Pourer



LV210P
Plastic



LV210S
Stainless steel



LV210A
Aluminum

wine thermometer series



WT-004



WT-005



WT-009



WT-007



WT-006



WT-008

Temperature C°/F

Humidity

infrared thermometer

wine & food



WT010

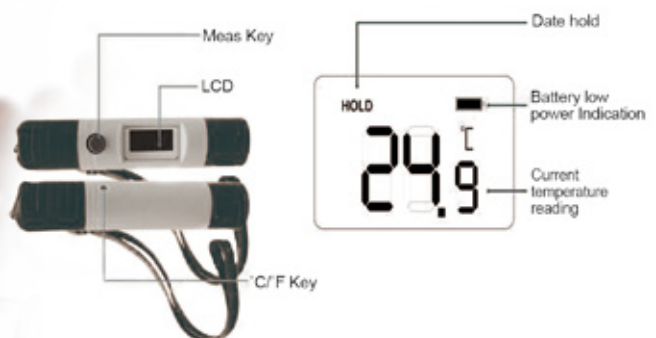

alcohol sensor

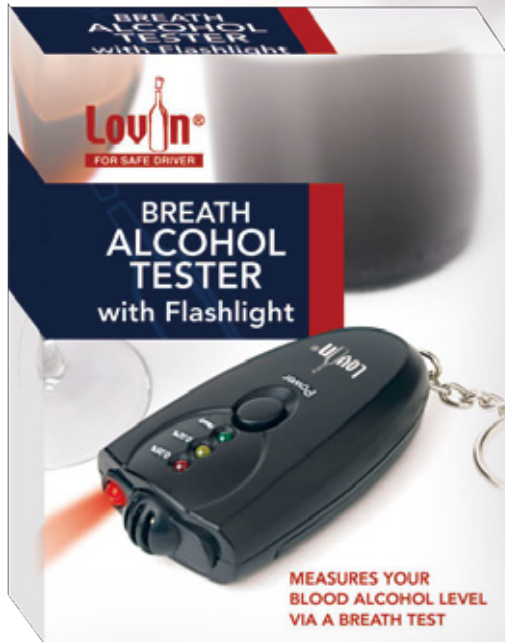

AS-01A



AS-01



AS-03



AS-02

bottle cooler pack



wine cooler clip



cooler base carafe

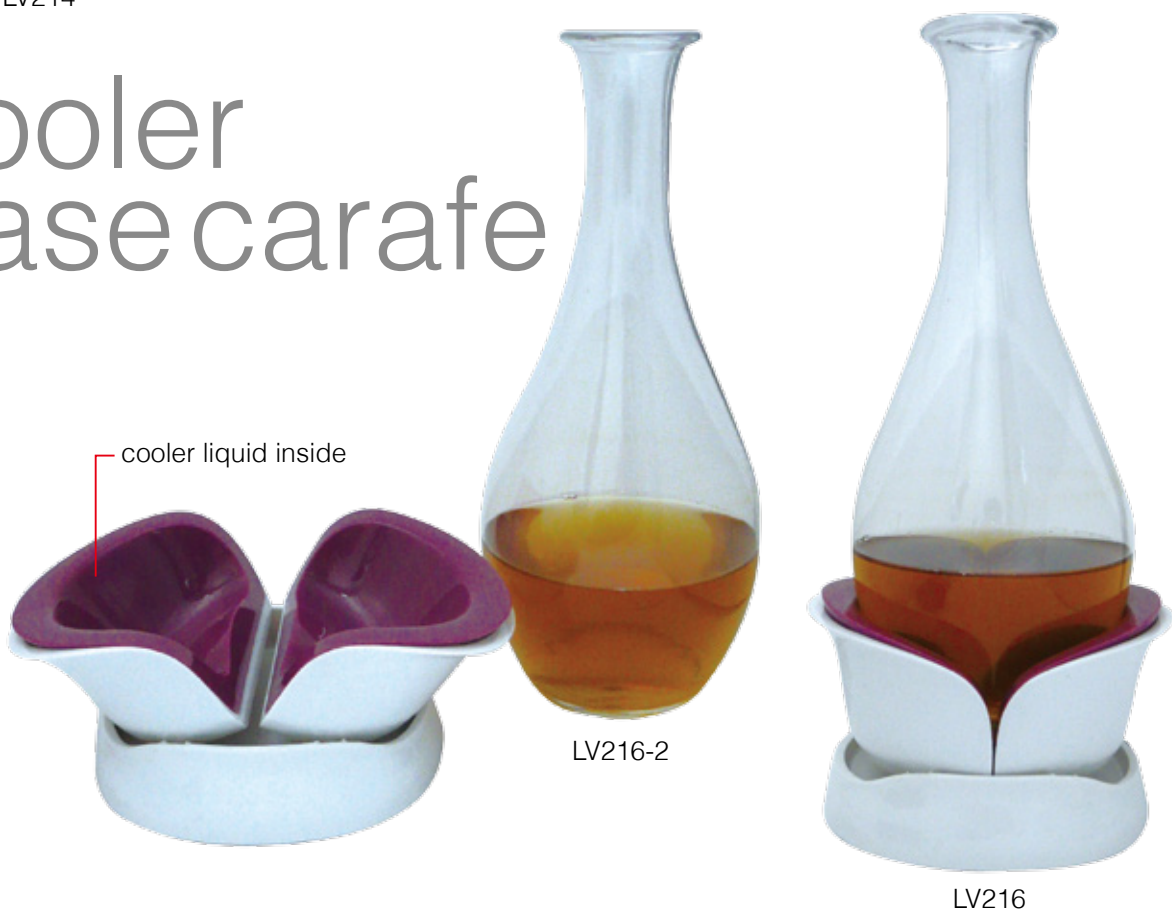

zinc alloy gadget series



stylish bar tools



CL0130

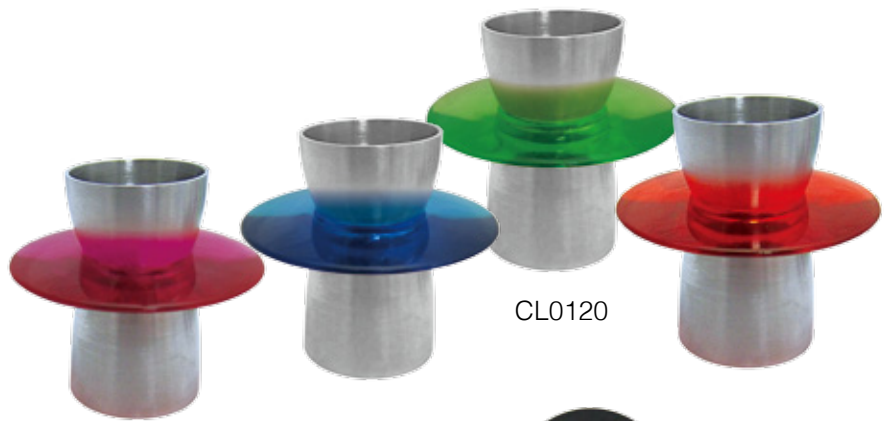

CL0120



CL0030P



SK07



TC01

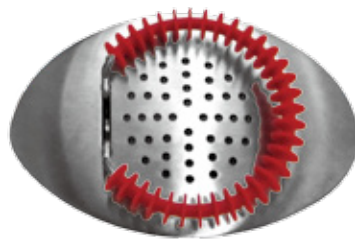

CL0140



IB63



Pink

Green

Solid red

Purple



DC01

Wine Decanter Carafe

1. Please put the bottle and decanter together as picture, turn the bottle around and leave the decanter on the table that allow wine runs from the bottle into the decanter
2. Turn the decanter around and let the wines run back into the bottle,
3. Decanting action could repeat few times if necessary.



1.



2.



3.





Wine Aerator

Some wine need to breath. Simply hold mini decanter over a glass and pour wine through.



WA01A
Aerator with
Stand



WA05



WA05A
Aerator with
Stand



WA01



WA02



WA03

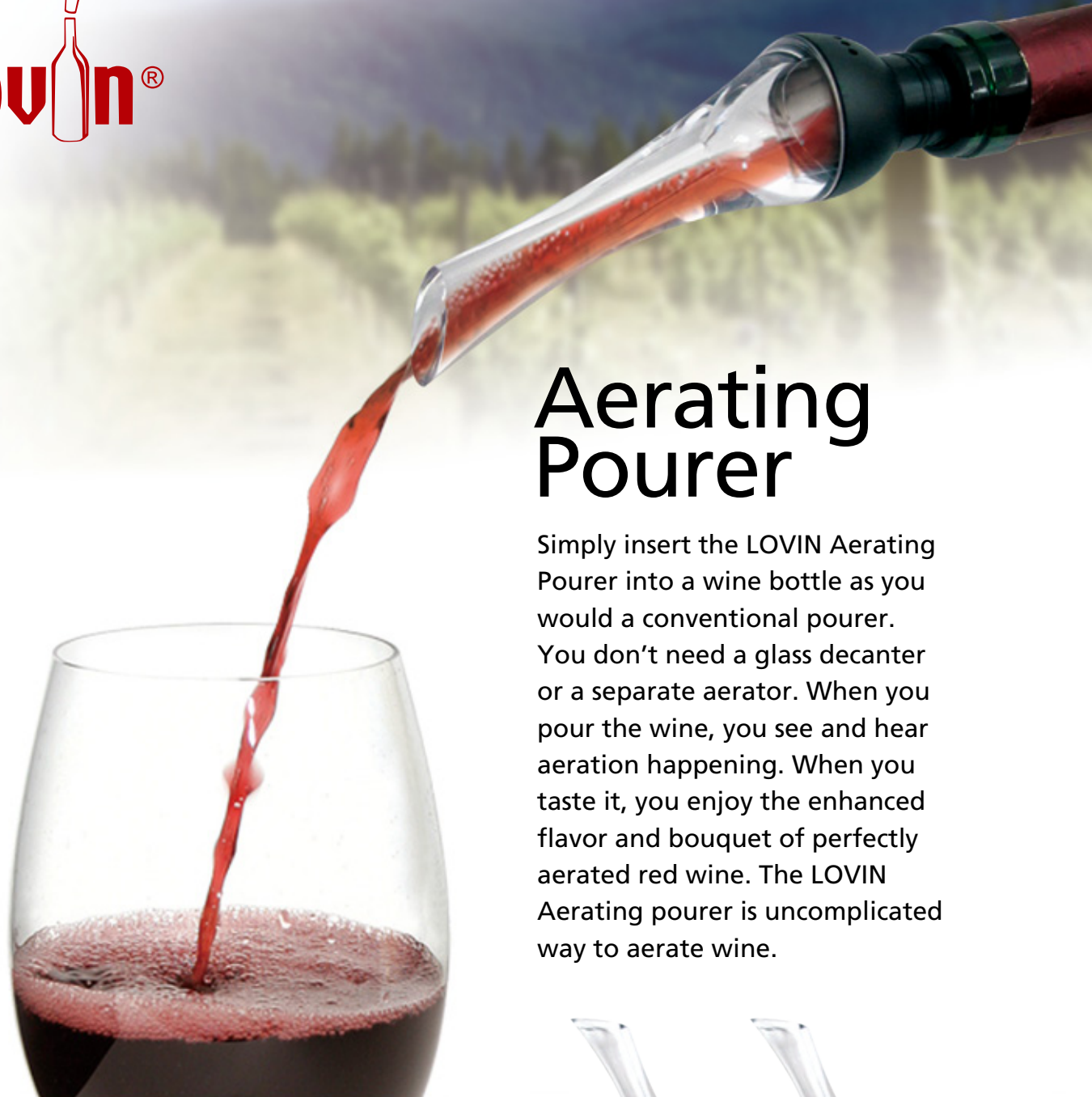

Aerating Pourer

Simply insert the LOVIN Aerating Pourer into a wine bottle as you would a conventional pourer. You don't need a glass decanter or a separate aerator. When you pour the wine, you see and hear aeration happening. When you taste it, you enjoy the enhanced flavor and bouquet of perfectly aerated red wine. The LOVIN Aerating pourer is uncomplicated way to aerate wine.

Key Features and Benefits

- Aerates red wine as you pour
- Improves flavor and bouquet
- Separates for easy cleaning
- Hand wash

Air in from here

Pour wine to glass

LV217



Black

Ruby



ELECTRIC Wine Preserver

Lovin introduces a faster, easier, more effective way to preserve red wine. The new battery-powered Electric Wine Preserver pulls to vacuum a wine bottle in 10 to 15 seconds, preserving the wine's flavor and bouquet for a week or more. This gift set includes the Electric Vacuum Pump and three stoppers in a plastic base. Push-button wine preservation has arrived!



LV210

Key Features and Benefits

1. Elegant and ergonomic soft grip, brushed buttons
2. Easy to use - push button and preserve; No more tiring up-and-down pumping required
3. One gentle push down, the pump automatically removes the air
4. Preserves wine in just 10 to 15 seconds
5. Includes 3pcs seal stoppers
6. 4PCS AAA# 1.5V battery





Wine Saver with Seal Stoppers

Delectation to wine preservation. Elegantly shaped wine saver, which extracts the air from the opened bottle and re-seals it with a re-usable rubber stopper. Place the stopper in the bottle and extract the air from the bottle by using the Wine Saver pump. The vacuum slows down the oxidation process so that you can enjoy your wine for a longer period of time.



LV5802



LV5800



1. Insert seal stopper into the neck of the bottle.



2. Take the pump on stopper; aim at the bottle and commence pumping action.



3. To re-open, press "PUSH" button slightly to release vacuum, then remove the stopper to pour the wine.



Vacuum Pump with Seal Stoppers

Our Stainless steel Wine Saver LOVIN has an integrated vacuum indicator. This will emit a clicking sound when the correct vacuum is reached.

The excellent stainless steel quality of applying a vacuum seal to opened bottles of wine to prevent oxidation. The LOVIN features a new larger capacity stainless steel and ABS plastic pump, plus re-usable stoppers to maximize the vacuum seal and an ergonomically shaped handle.

Using the special re-usable rubber stopper and the Wine Saver LOVIN, allows you to extract the air from the opened bottle. This slows down the oxidation process, which manipulates the taste, so that you can enjoy your wine for a longer period of time.



LOVIN Vacuum Pump
with 2 Seal Stoppers

LV02



LV02-4P



ABS Plastic

Stainless
Steel Pump

ABS Plastic

Push Button

Soft Rubber

NEW

USER INSTRUCTION



1. To clean stopper before use for optimal vacuum. Insert the stopper into the neck of the bottle.



2. Take the pump on stopper; aim at the bottle and commence pumping action. Remove pump after pumping 8-10 times depend on wine level inside the bottle; and store bottle upright.



3. A vacuum seal stopper can keep about 5-7 days for opened bottles of wine.



4. To re-open the bottle, press "push button" slightly to release vacuum, then remove the stopper to pour the wine.

wine decanter & funnel

LV06-1



LV06-3



LV50



LV18



stainless steel ice cube



ICE01

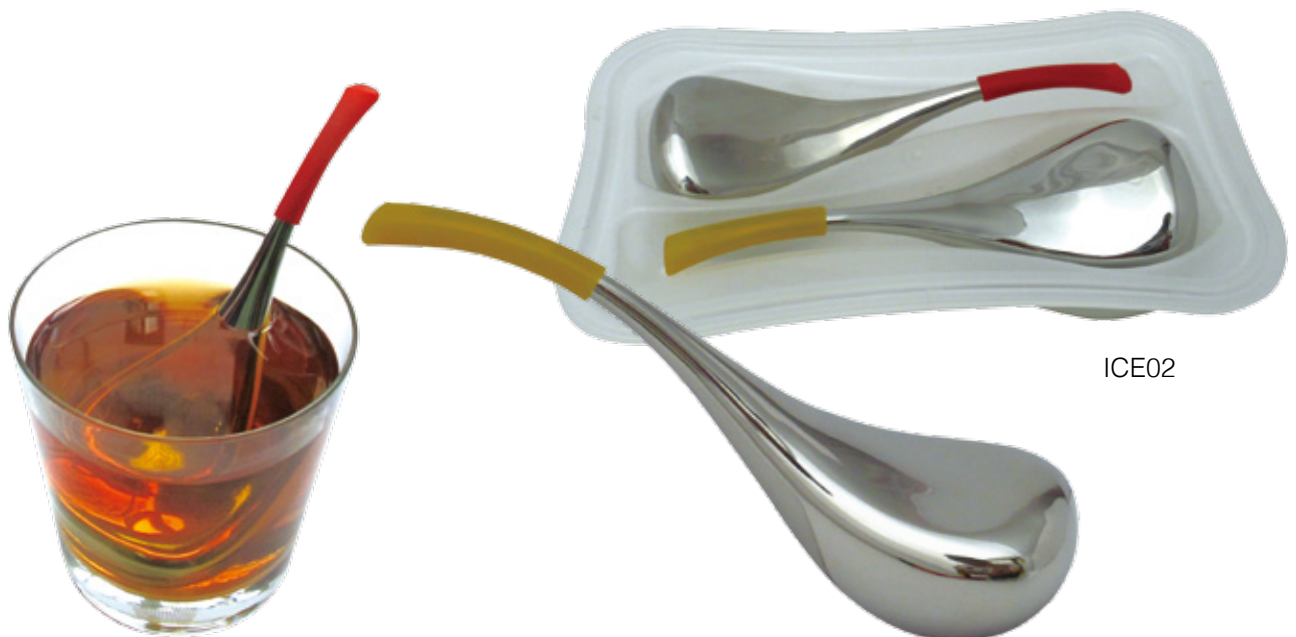

ICE02

Wine chilling stick



How to use:

Your just-opened bottle of wine will chill and keep at the perfect temperature; that is the technology behind this freezable Wine Chill Stick.

Open your bottle, pour out about 50ml, insert the Wine Chill Stick, and pour. It will keep your favorite Riesling or Chardonnay at the perfect temperature during the party.

Keep the Wine Chill Stick frozen and ready in your freezer; it needs to freeze for at least one hour for optimal chill.



bar accessories



LS01



LS02



LS03



LS04



LS05



GP008



GP009



SC0034



SC0035



SC0036



SC0037



GP006



GP005



GP004



GP003



GP002



GP001





BC301



BC302



BC303



BC304



BC305



BC306



BC307



BC308



BC309



BC310



BC311



BC312



BC313



BC314



BC315



BC317



BC316



BC318

wine accessories



WS4200

LV02

LV02-W

LV205

LV206



LV5803

LV5802

LV209

LV208

LV207



CL010

CL011

CL012

CL013

CL0090

CL110

AS301



CL0040



CL0020



CL0100



CL0040B



CL0020B



AA720

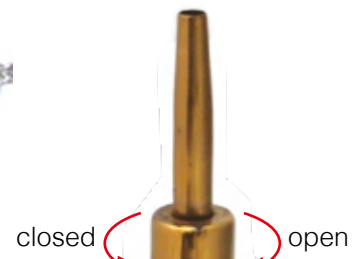

CL120

Black



White



CL150

Sliver



CL150



CL0050



CL0060



CL0070



CL0030



CL0080



C5



C6



C7



C8

mini vacuum stoppers





WT-BOX



WT-301



WT-302

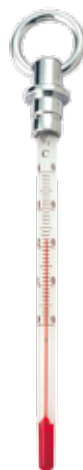

WT-303



WT-304



AA722



FC1020



FC1030



FC1050



FC1060



AA721



WS4020



WS4000



LV03



LV04



AA714



AA715



AA716



AA713



AA718



AA719

wine charms, silicone stoppers & fruit forks



WC110



WC109



WC106



WC105



WC108



WC107



wine charms



WC100



WC101

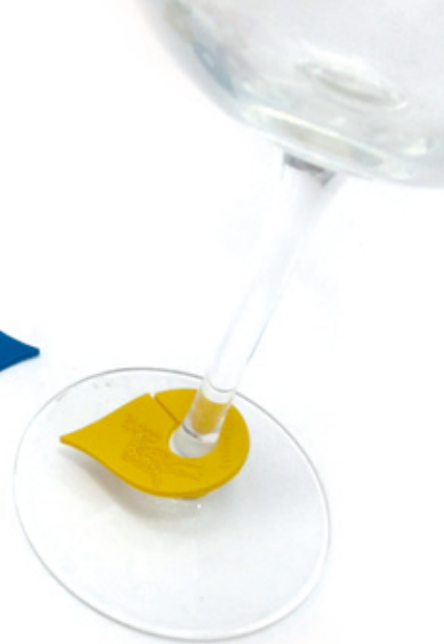

WC102



WC103



WC104





PRESTAGE

corkscrew for sommelier



INNOVATION

waiter's friends



BC09



BC10



LV01



BC19



BC08



BC11



BC12



BC13



BC26



BC27



709C



BC15



BC16



BC17



709C-1



709C-2

waiter's friends



waiter's friends



kitchen & bar utensils



stainless steel shakers & parts



stainless steel shakers & jiggers



WATER DECAL+LASER

ABS PLASTIC+SILICON
+STAINLESS STEEL



COATING+SCREEN PRINT



LEATHER+LASER



REAL LEATHER



40/20
jj05

45/45
jj06

30/50
jj07C

40/20
jj08

30/50
jj07G

30/20
jj09

Hip Flask



Silk Screen



PVC Printing



Rubber with
Silk Screen



Laser



Water Transfer



PU with
Heat Transfer



PU Emboss



Deboss



Emboss

metal mugs/cups



MM61G

Top:85mm
Bottom:80mm
Weight:160g
Capacity:400ml



MM61

Top:85mm
Bottom:80mm
Weight:160g
Capacity:400ml



MM09

Top:75mm
Bottom:66mm
Height:90mm
Weight:177g
Capacity:470ml



MM08

Top:85mm
Bottom:55mm
Height:100mm
Weight:155g
Capacity:550ml



MM16

D:80mm
Height:92mm
Weight:105g
Capacity:420ml



MJ01

Top:68mm
Bottom:55mm
Height:175mm
Weight:228g
Capacity:280ml



MA02

Top:85mm
Bottom:65mm
Height:120mm
Weight:65g
Capacity:350ml



MM19

D:67mm
Height:95mm
Weight:153g
Capacity:340ml



MB03

Top:89mm
Bottom:92mm
Weight:350g
Capacity:600ml



MK05

Top:85mm
Bottom:60mm
Height:100mm
Weight:275g
Capacity:550ml



MS09

Top:75mm
Bottom:65mm
Height:90mm
Weight:120g
Capacity:430ml

ice bucket



SSB02
Ø12*19.5H



SSB03A Ø12*Ø15*19.5H
SSB03B Ø12*Ø14*19.5H



SSB04
Ø13*Ø10*19.5H



SSB05
Ø16.5*Ø13*26.5H



SSB06
Ø13*19.5H



SSB07
Ø13*Ø16.5*26.5H



SSB08
23(Top)*13 (Base)*19.5H



SSB09
Ø22.5*25H



SSB10
Ø18.6*Ø14.5*20H



SSB11
Ø22*Ø14*23H



SSB12
Ø20.8*Ø13.3*20.7H



SSB13
Ø20.8*Ø13.3*20.7H



SSB14
Ø18*18H



SSB15A Ø12.8*Ø12*17.3H
SSB15B Ø10.8*Ø9.5*15.5H



SSB16
Ø16.8*19H



SSB17
Ø16.8*17H

ice bucket



SSB18A Ø16.1*18.7H
SSB18B Ø16.4*24.5H
SSB18C Ø21.5*26.5H



SSB19A Ø15.5*15.5H
SSB19B Ø19*19H



SSB20A Ø12*15H
SSB20B Ø15.5*17H
SSB20C Ø19*19H



SSB21A Ø12*15H
SSB21B Ø15.5*17H
SSB21C Ø19*19H



SSB22
Ø18*19.5H



SSB23
Ø42*34*24.5H



SSB26
Length: 74.5



SSB28
Ø14.5*16.5H



SSB24
39*22.5*23H



SSB25A Ø35.3*22.5H
SSB25B Ø39*Ø24.5H



SSB29
Ø12*18H



SSB29A Ø32*2.7H
SSB29B Ø37.5*2.7H



SSB30A Ø36.3H
SSB30B Ø38*2.5H



SSB31
25.5(L)*15.5(W)*2H

gift set references



Set 1



Set 2



Set 3



Set 4



Set 6



Set 7



Set 11



Set 8



Set 9



Set 10



LV201P



LV03D



LV04D



WA02D



LV206 Set



LV02D

napkin holders



NP01
Height 10.5cm
Width 14.8cm
Length 24cm

NP02
Height 10.5cm
Width 14cm
Length 15.3cm



NP03
Height 15cm
Width 12.5cm
Length 16.3cm



NP05
Height 15.8cm
Width 22cm
Length 15.2cm



NP04
Height 13cm
Width 15.5cm
Length 20.3cm





bar table items



NP02B



Coaster



NP02A

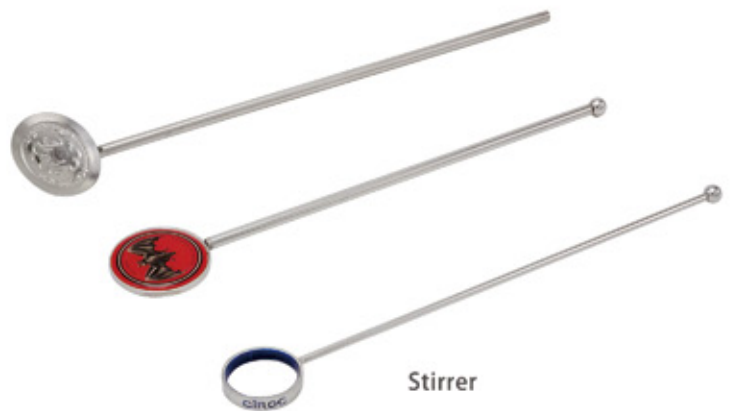

Stirrer



Top:86mm
Bottom:66mm
Height:110mm
Weight:51g
Capacity : 450ml



Top:90mm
Bottom:65mm
Height:115mm
Weight:74g
Capacity : 450ml



Top:110mm
Bottom:69mm
Height:120mm
Weight:74g
Capacity : 530ml



top:95mm
Bottom:63mm
Height:120mm
Weight:12g
Capacity : 450ml



NP02A

metal napkin holders



MNP01
STAINLESS STEEL

Size : 25.4(L)*15(W)*11.2(H)CM
Weight:1030g



MNP01B
BLACK COATING



MNP02G
GOLD PLATING

Size : 16.1(L)*13(W)*10/8(H)CM
Weight:400g



MNP02B
BLACK COATING



MNP03C
INNER INJECTION
Size : 19(L)X19(W)X11(H)CM
Weight:850g



MNP04
INNER SPRAY
Size : 19.5/13.2(L)X14/12.2(W)X13.5/11(H)CM
Weight:835g

cooler with MP5 video

IB46

Height 21.5cm

Top 34.3cm

Base 20cm

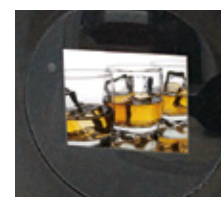

Video player

Speaker

LED light display

DL-03

Height 10cm

Width 13.5cm

Length 46.5cm



DL-02

Height 9cm

Width 13cm

Length 39.5cm



DL-01

Height 8.5cm

ø 21cm



light cuffs



DL-04

Height 5cm

ø 11.5cm

DL-05

Height 6.5cm

ø 11cm



LED light display bottle glorifier



DL-06
Width 43cm
Length 28cm

DL-09
Width 30cm
Length 39cm



DL-08
High 35cm
Width 13.5cm
Length 40cm



DL-07
Width 40cm
Length 30cm



DL-10
High 16cm
Width 23cm
Length 11cm



DL-11



DL-12



DL-13



DL-14

The LED menu models

- ◆ LED-backlit is adopted for gentle illumination
- ◆ Rechargeable lithium battery-powered
- ◆ Long operation time & wireless
- ◆ Covered with elegant leather
- ◆ Translucent paper inserts can be self printed

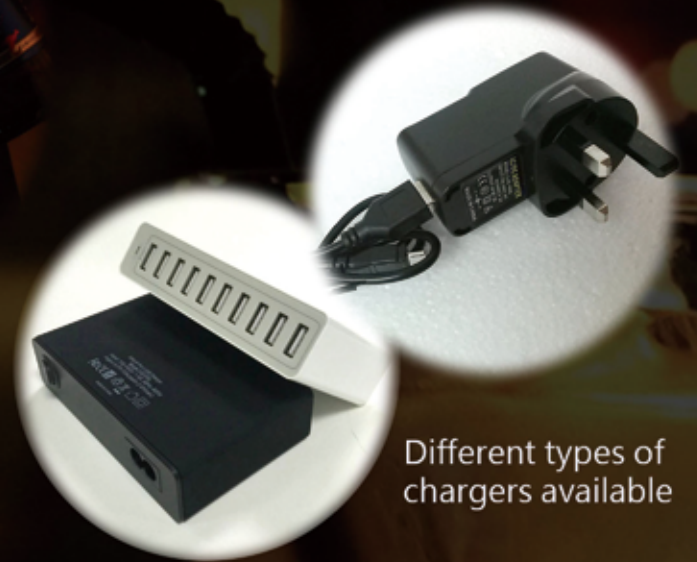

Different types of chargers available

Model A 1 Panel 1 Light View



front

back

Model B 1 Panel 2 Light View



front

back

Model C 2 Panel 3 Light View



front

back

Model D 2 Panel 4 Light View



front

back

Insert Size: F4, A4, A5, Legal 8.5" x 14", 5.5" x 11", 5.5" x 8.5"

The LED menu models

Model E 2 View Table Tent



Insert Size:
A6, A5

Model F 3 View Table Stand



Insert Size:
1/3 A4 3.9" x 8.3"
1/2 A4 4.15" x 11.7"

Model G Bill Folder



▼ Magnet Clip

Light Panel Size:
3" x 7.8"

▲ Cash Pocket

Model H LED Signal Board

Insert Size:
A2, A3



▲ can be wall-mounted



with stand
(Optional)

Customisation Available

Various Material Options



Logo Decorations



Blind Deboss



Foil Stamping in Gold



Foil Stamping in Silver



Silk Screen Color Printing



UV Printing (Multi-color)



Metal Plate



Embroidery

Insert Size: A3, F4, A4, A5, Letter 8.5" x 11", Legal 8.5" x 14", 4.25" x 11" 4.25 x 14" or more
Packing Details: OPP bag + Bubble sponge + Carton

cooler with LED light



IB49LED
Height 24.5cm
Top 40.5/28.5cm
Base 28.5/22cm



IB52LED
Height 40cm
Top 30cm
Base 24cm

cooler 10 - 12 litres

IB48
Height 26cm
Top 26/35.5cm
Base 21cm
Single Injection



IB47
Height 26cm
Top 26.5/34.5cm
Base 21cm
Double Injection

ice buckets 10 litres



IB13-Wood
Height 21cm
Top 26cm
Base 26cm



IB13-Red



IB13-Black



IB11
Height 20cm
Top 27cm
Base 27cm



IB33
Height 24.5cm
Top 28cm
Base 26.5cm



IB16
Height 18.5cm
Top 29.5cm
Base 29.5cm





IB51A
Height 21.5cm
ø 28.5cm
Size 10L



IB51B
Height 22cm
ø 29cm
Size 10L



IB63
Height 28cm
ø 19.5cm
Size 8L

table cooler 50 litres



IB60
Height 57/85cm
ø 50cm
Size 50 litre capacity



ice buckets 5 & 7 litres



IB08

IB08/09
Height 21.5cm
Top 26cm
Base 22cm
Size 7 litre capacity



IB09

IB10
Height 17cm
Top 26.5cm
Base 20cm
Size 7 litre capacity



IB12
Height 21cm
Top 18.5cm
Base 18.5 cm
Size 5 litre capacity

IB17C
Height 20.2cm
Top 19cm
Base 19 cm
Size 5 litre capacity



IB17
Height 20.2cm
Top 19cm
Base 19cm
Size 5 litre capacity



IB17B
Height 22cm
Top 19cm
Base 19cm
Size 5 litre capacity

ice buckets

other capacity



IB19
Height 12cm
Top 14.5cm
Base 14.5cm
Size 1.2 litre capacity



IB29
Height 16.5cm
Top 17cm
Base 17cm
Size 2.3 litre capacity



IB59
Height 13cm
Ø 12cm



IB18
Height 21cm
Top 21cm
Base 18.5cm
Size 3.5 litre capacity



IB07
Height 15cm
Top 15cm
Base 11.5cm
Size 1.2 litre capacity



IB30
Height 18cm / 25cm
Top 23cm
Base 13cm
Size 4.5 litre capacity



coolers



IB65
Height 11.5cm
Top 13.5cm
Base 10cm



IB02PS
Height 18cm / 25cm
Top 23cm
Base 13cm
Net weight 1160g
Thickness 7mm
Material PS-twice injection



IB20PP
Height 18cm / 25cm
Top 22cm
Base 13cm
Net weight 900g
Thickness 6.5mm
Material PP-single injection



IB06
Height 18cm / 25cm
Top 22cm
Base 13cm
Net weight 390g
Thickness 3mm
Material PP-single injection





PS



IB01

Height 18.5cm / 24cm
Top 19.5cm
Base 10cm
Net weight 675g
Thickness 7mm
Material PP-single injection

PP



PP



IB21

Height 21cm
Top 20.5cm
Base 14cm



IB63

Height 18.5/24cm
Top 19.5cm
Base 9cm
Net weight 350g
Thickness 35mm



ABS

IB04

Height 23cm
Top 14.5cm
Base 12.5cm
Net weight 450g



PS



ABS

IB03

Height 22cm
Top 12.5cm
Base 12.5cm
Net weight 440g



PS

coolers

IB53
Height 22cm
Top 22.5cm
Base 15cm



IB47B
Height 20cm
Top 27cm
Base 16cm



IB47C
Height 20cm
Top 27.2cm
Base 16cm
Double Injection



IB54
Height 21.5cm
Top 21cm
Base 14cm



PP



IB22
Height 19.5cm
Top 25cm
Base 10cm



IB62
Height 21cm
Top 18/18cm
Base 18/18cm



IB55
Height 26/14.5cm
Top 18.5cm
Base 13cm



IB56
Height 26/14.5cm
Top 23/18.5cm
Base 16/12cm

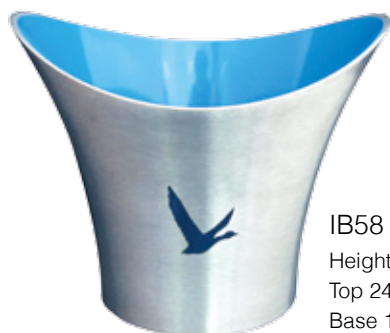

IB58
Height 20cm
Top 24.8cm
Base 14cm



IB57
Height 14.5cm
Top 32cm
Base 18.5cm
Size: 10 litres

IB66
Height 31cm
Top 20.8cm
Base 12.5cm
Size: 4 litres





Aluminum



IB23
Height 21cm
Top 22cm
Base 9.5cm



PP

IB32
Height 17cm / 22cm
Top 18cm
Base 9.5cm



IB05
Height 19cm / 25cm
Top 27cm
Base 12.5 cm
Net weight 1170g
Thickness 8mm



IB25
Height 23.5cm
Top 20/24cm
Base 14.5/18cm

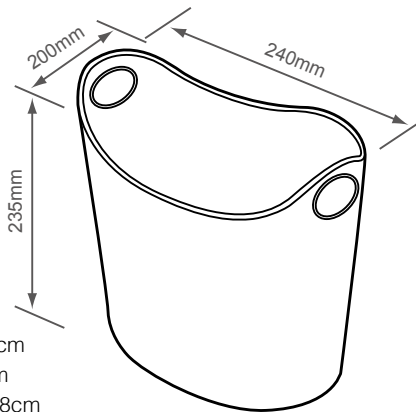

IB28
Height 22cm
Top 21cm
Base 16cm



IB27
Height 22cm
Top 21.5cm
Base 15cm



IB31
Height 25cm
Top 20.3cm
Base 11.5cm



IB24
Height 26cm
Top 22.5/21.5cm
Base 12cm



Fill ice water
in block

IB26
Height 23cm
Top 33/20cm
Base 21/16cm

pitchers



PH08
Height 20.5cm
Ø 12.8cm
Size 1300ml



PH07
Height 23.5cm
Ø 15.5cm
Size 2000ml



PH01
Height 23.5cm
Ø 14.5cm
Size 1500ml



PH02
Height 23cm
Ø 13cm
Size 2400ml



PH04
Height 14.3cm
Ø 18cm
Size 1000ml



PH03
Height 23cm
Ø 13cm
Size 1500ml



PH05
Height 22.5cm
Width 14cm / Length 9cm
Size 1500ml



PH06
Height 20cm
Ø 13.5cm
Size 1000ml



serving trays



TR04
Ø 22cm x 4cm



TR01
Ø 30cm x 5.5cm



TR03
Ø 36cm



TR02
Ø 31cm



TR07
Ø 37cm



TR05
Ø 35.5cm x 5.5cm



TR06
Ø 37cm





Ice ball maker

TR11

Height 7cm
Width 8.5cm
Length 24cm



TR10

Height 10cm
Width 16cm
Length 50cm

TR09

Height 11.8cm
Width 15cm
Length 19.8cm



Tea box in
acrylic

TR12

Height 6.5cm
Width 17cm
Length 19cm



TR08

Ø 23 x 7 x 5.5cm



POPCORN FEAST

6 pieces set



plastic glasses



PG06
Height 19cm
Ø 5.2cm
Size 190ml



PG03
Height 19cm
Ø 8cm
Size 280ml



PG02
Height 20.3cm
Ø 6cm
Size 150ml

PG01
Height 16cm
Ø 6.2cm
Size 200ml



PG04
Height 16.3cm
Ø 7cm
Size 360ml



PG05
Height 12.5cm
Ø 7cm
Size 200ml



PG11
Height 10.8cm
Ø 9.6cm
Size 300ml



PG09
Height 14.5cm
Ø 9cm
Size 400ml

PG12
Height 11.2cm
Ø 8.2cm
Size 250ml



Purple

PG07
Height 21cm
Ø 6cm
Size 200ml



PG10
Height 14.3
Ø 9.4cm
Size 120ml

Red



Yellow



PG08
Height 21cm
Ø 7.8cm
Size 230ml



Light blue

plastic shakers

CPS07
700ml



CPS01
550ml



CPS02
400ml



CPS08
1000ml



CPS03
400ml



CPS04
350ml



CPS05
250ml



CPS06
150ml



drop stopper



DS001



other promotion items



LV05 - Champagne stopper



LV19 - Wine stopper

RTD05



RTD01 - Bottle Cooler
D: 8cm (7.8 inner)
H: 13.2cm
Foam: 0.5m-1cm



RTD07 - Twisted shot glass



RTD09 - Candle holder



RTD08 - Shot glass



RTD02

RTD03

RTD04

RTD06

LV04B

LV04A



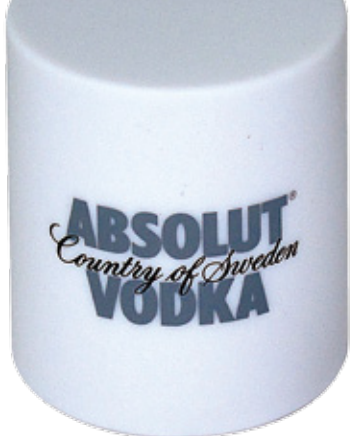

DC05

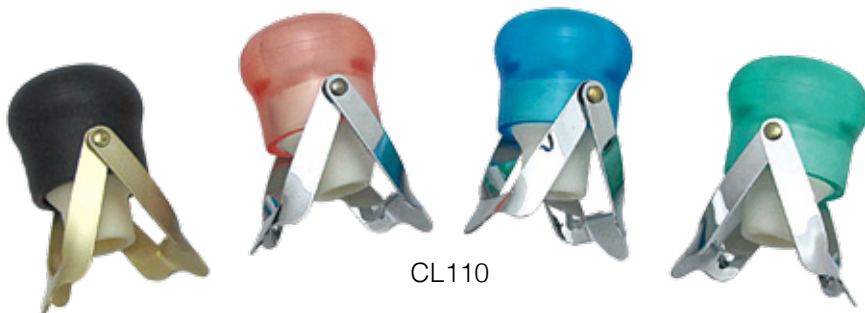

CL110



CL130



DC01



DC07



RTD07
USB stick



DC04



DC06



DC03



DC02

Coaster



CR02

CR03



CR05

CR04

drinking straw & stirrer



Plastic stirrer



Plastic straw



Stainless
steel straw

drink dispenser



DD-01



DD-02



DD-03



DD-04



DD-05



DD-06



DD-07



Bar Mat





wooden items



SIZE: 29*29*23 (H) CM

WOODEN ICE BUCKET WITH PLASTIC INNER



SIZE: 260*155*110MM

THINNESS: 5MM

WOODEN BAR CANDY



SIZE: 29*29*23 (H) CM

WOODEN ICE BUCKET WITH BAR GAMES



HEIGHT: 245MM
HANDLE SIZE: 50*150MM
BOTTOM: 75*90MM

WOOD MUDDER



HEIGHT: 235MM
TOP: 35MM
BOTTOM: 45MM

WOOD MUDDER



HEIGHT: 28CM
BASE: 90*100*45MM
WOOD HAMMER



SIZE: 34*19.5*10CM

2 BOTTLE WINE WOOD BOX



SIZE: 330MM
BASE: 150*50MM

WINE OPENER HOLDER/
CHEESE TOOLS



WINE OPEN DISPLAY BOARD

BARWARE ITEMS FOR PROMOTION

BOMBAY  SAPHIRE®



GREY GOOSE WING LINE SERIES

GREY GOOSE®
—VODKA—



SIP RESPONSIBLY. © 2009 GREY GOOSE AND GREY GOOSE AND DESIGN ARE REGISTERED TRADEMARKS AND THE FLYING GOOSE DEVICE IS A TRADEMARK IMPORTED BY GREY GOOSE IMPORTING COMPANY MAHI, FL VODKA 40% ALC. BY VOL. FLAVORED VODKAS EACH 40% ALC. BY VOL. DISTILLED FROM GRAIN.

product development 1



product development 2



product development 3



product development 4



product development 5 Stella Artois



Big Ice Bucket



Ice Bucket



Napkin Holder



Foam Cutter



Candle Holder



Menu Holder



Opener



Coaster Holder



Tray-1



Tray-2

product development 6



product development 7



product development 8

NOAH COLLECTION



product development 9

DIAGEO'S ITEMS



bar tools collection

